

**Alat za jednostavniju montažu Cap konektora**

**Alat za blankiranje**

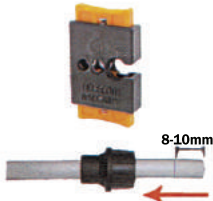

**Skidanje spoljašnje izolacije**

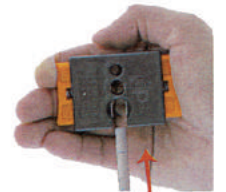

Pritiskom razdvojite sečiva staviti kabal između sečiva

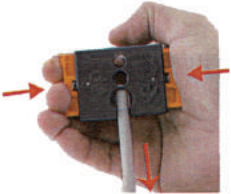

Postiže se skidanje spoljne izolacije

**Skidanje širma/folije**

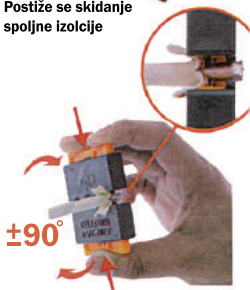

Pritisnite i rotirajte sečivo i kabl  $\pm 90^\circ$



**Plastična klešta za instalaciju**



**NEPRAVILO** držanje klešta

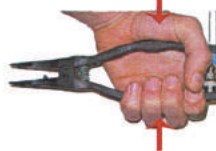

**PRAVILO** držanje klešta

Uhvatite klešta što bliže konektoru

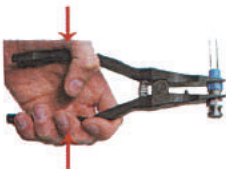
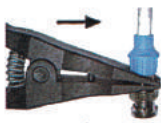

**Push-Pull alat za instalaciju**

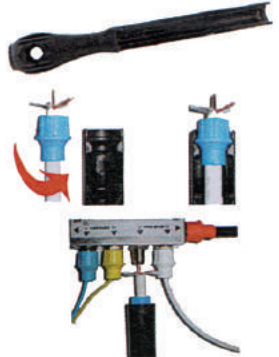

**Ubacivanje**

Postavite na konektor

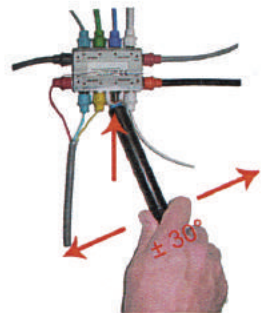

Rasklimajte levo desno

**Izvlačenje**

